



**DECEMBER 4, 2023**

**MCMEEN**  
**CSC MEETING**

COLLABORATIVE SCHOOL COMMITTEE



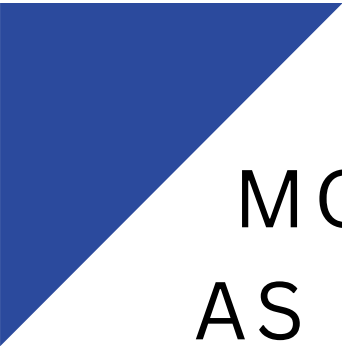

MCMEEN ELEMENTARY STANDS  
AS A SCHOOL OF EXCELLENCE IN  
WHICH EVERYONE IS SAFE,  
RESPECTED AND CELEBRATED.  
TOGETHER WE CREATE 21ST  
CENTURY THINKERS WHO  
CONTINUE TO ACHIEVE AND  
INNOVATE. WITH OUR TEACHERS,  
FAMILIES AND SURROUNDING  
COMMUNITY WE EMPOWER  
CULTURALLY AWARE  
INDIVIDUALS TO BECOME  
ALTRUISTIC, COMPASSIONATE,  
AND INTRINSICALLY MOTIVATED  
MODELS FOR WHAT IS TRULY  
EXCEPTIONAL.



**OUR VISION**

# AGENDA

- FAMILY ENGAGEMENT
- SCHOOL DETERMINED FUNDS FOR UPGRADES
- SCHOOL UPDATE

PLEASE BE SURE TO ADD YOUR NAME TO THE CHAT FOR MEETING ATTENDANCE



# Family Engagement

46 Respondents

Share the responses so everyone can consider it, then we can discuss possible implications and next steps

Question 1: In your opinion, what invitations to engagement have been successful?

- Weekly emails (11)
- Personal connections (4)
- Events at school (17)

# Family Engagement

Question 2: What ideas do you have for other ways to increase parent engagement with the school, Parent Teacher Organization (PTO), or Collaborative School Committee (CSC)?

- Vary the time of day and day of week (9)
- In-person vs. Virtual vs. Hybrid (3)
- Idea of having communication in a central location came up in a few different ways
- More personal/individual communication (5)
- Class or Room Parents / Volunteer Leaders (5)
- Appreciative of when Childcare is provided (3)
- Smaller commitments for volunteering as well as clarity around what a commitment entails (2)

# Family Engagement

Question 3: What hurdles or obstacles to parent/guardian engagement have you seen?

- Time/Place (14) including other commitments (14)
- Communication that is last minute (3) and/or not consolidated (3)
- Feeling like there is too many things going on (for example, too many awards ceremonies) (2)

Question 4: In what ways would you like to engage with the school?

- Volunteering in classroom (11)
- Meet with Leadership (2)
- Donate (2)
- Community Events (8)

# Family Engagement

What are some takeaways or possible next steps?

- Classroom Parent - Room Parent Coordinator (Parent - PTO Position)
- Information that is prioritized - Ideas: on a Monday morning, this is what's coming up this week
- Website/source to look for information
- Collect additional information on who is receiving information
- Personal communication
- Consolidating information - linking to other information so those who want it can go find more



# 2020 Bond School Determined Funds - 2023-24

*Innovative, Modern & Impactful*



# School Determined Funds

School Determined Funds (SDF) is an investment area under the 2020 Bond Quality Learning Environments category. Similar to Innovative Classrooms and Focused Investments in the 2016 Bond, this program provides funding to facilities for school-driven high-impact investments in key learning environment spaces.

## **Building Eligibility:**

- Buildings constructed prior to 2010, and without a significant renovation within the last 10 years
- DPS owned or DPS leased buildings

## **Funding Allocation Variables:**

- Funding amount for project budgets will be based on the original grade level design of the building
- Subcommittee and BoE decided to provide additional funding for schools with high equity index scores

## **Spending Guidelines:**

- Schools will have flexibility in implementation within guidelines for allowable investments in key learning environment spaces (classrooms, cafeterias, outdoor play areas, libraries/LMCs, flexible program spaces, gyms/fitness spaces, school gathering spaces, auditoriums)

# School Determined Funds

## Facility Funding Levels

Funding amount for project budgets will be based on the original grade level design of the building. Funding levels are per facility - regardless of # of school programs, or enrollments in the facility.

ECE/Elementary \$100,000

During the Bond Planning process, the Community Planning & Advisory Committee (CPAC) and Board of Education allocated additional funding to campuses that had higher Equity Index scores (based on 2019-20 data):

- Campuses with Equity Index score above 1.0 (District Average): \$25,000
- Campuses with Equity Index score 1.4+ (top quartile in District): \$50,000

# School Determined Funds

## Examples of Eligible Environments for Funds Allocation

Schools will have flexibility for allowable\* investments within key learning environment spaces. Encourage schools to invest in 1-2 areas in order to maximize investment and transform space.

Auditorium	New flooring, repaired seating, AV system upgrades
Cafeteria	Flexible seating options, updated flooring and wall paint, water bottle fill stations
Center Based Classrooms	Updates to center classrooms in support of center students
Classrooms	Markerboards (remove chalkboards), window coverings for presentations, furniture
Corridors	Updates to corridors in support of transitions
Flexible Program Space (eg, STEM lab)	Updates to classrooms/spaces that could be used for project-based learning
Gym/Fitness Center	Updates to flooring, painting, equipment, seating
Library/LMC	Updated furniture, technology, paint, flooring
Main Office	Update existing finishes, furniture and technology
Outdoor Play Area	Updated equipment, options for play and learning (no asphalt repair)
School Gathering Space (eg., community room, College & Career centers)	Updates to spaces to support school community uses
Stairwells	Improvements to stairwell to support transitions

\* Examples of investments not allowed with these funds: heating/cooling, re-paving, elevators, Student / Staff technology devices (unless connected to a lab scope)

# Phase 4 SDF - 2023-2024

## Timeline for Project

Timeframe	Activity
May - August 2023	Conduct building assessments
September	School leader kick-offs (introduction to SDF Program)
Early October	Project Manager schedules meeting with school leader to review budget, scope opportunities
October - November	<p>School community scoping</p> <p><i>Stakeholders should represent each school and include e.g., school leader, teachers, students (whenever possible), parents, facility manager</i></p> <p><i>Use shared campus meetings to coordinate on scope prioritization from school communities</i></p> <p><i>Schools gather input/communicate to broader school community outside of meetings (check with CSC/ school governance committee, student council, newsletters, surveys, etc)</i></p>
By Thanksgiving	School leaders submit a google form with scope
December - May 2024	Vendor, contractor procurements
Summer 2024	<p>Construction / project execution</p> <p><i>Depending on complexity of scope selected, goal to complete project in summer 2024</i></p>



# Images of Recent Transformations

# Photos

## Cafeteria Upgrades

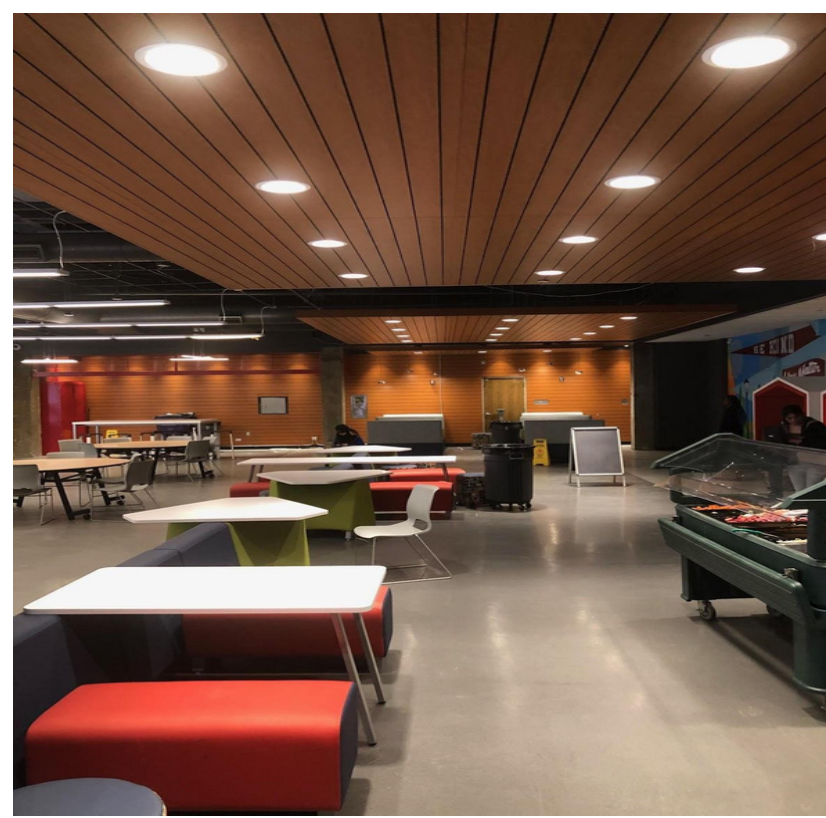

# Photos

## Center Classrooms



# School Determined Funds

2023-2024 SCHOOL-DETERMINED FUNDS (\$125,000)

1. PAINT ALL CORRIDORS GLAZED BRICK WHITE WITH BLUE ACCENT ON TOP OF BRICK, INCLUDING THE STAIRWELLS.
2. POPS OF COLOR IN THE CORRIDOR FLOORING
3. PAINT ALL EXTERIOR DOORS BLACK ON THE INSIDE
4. MAIN OFFICE AND OFFICES - PAINT AND FLOORING
5. MURALS IN STAIRWELLS

## Feedback, thoughts and ideas from CSC?





Cafeteria is very loud – adding noise buffers

Keep on the radar – addressing lead in the water

Keep asking for AC

Cooling white paint on the roof



- 
- 
- 
- 
- PRINCIPAL RESIDENT
  - FY25 BUDGET DEVELOPMENT  
TIMELINE/ PLANNING FOR THE  
2024-25 SCHOOL YEAR
  - CLASS SIZES

**SCHOOL  
UPDATE**

# FY25 BUDGET DEVELOPMENT TIMELINE PLANNING FOR THE 2024-25 SCHOOL YEAR

## Nov 2023 to Mid-Jan 2024: Pre-Budget Planning and Preparation

- Pre-Budget planning and discussions with School Leader, Collab Dir, FP, HRP
- CSC MEETINGS - School leaders must meet with their CSC during the budget development process, and in any event no later than the day before Budget Forms are due back to the Budget Office. Schools must not wait to discuss the budget with the CSC until the last minute.

November 28	ENROLLMENT PROJECTIONS - Nov 28 (Tue) – Preliminary Enrollment Projections
December 8	Deadline for Principal feedback on enrollment - Principals must submit feedback, if any, directly to the Enrollment & Choice team according to their instructions
December 15	School’s wishing to exceed the 4 FTE/10% reserve limit for the 2024-25 school year must submit a plan for how they intend to use the funds in next year’s budget. Decisions will be communicated by January 5
January 12	Final Enrollment Projections (Leader Weekly, FPs email Principals)
January 17	Superintendent & CFO call with Principals

# FY25 BUDGET DEVELOPMENT TIMELINE PLANNING FOR THE 2024-25 SCHOOL YEAR

Mid-Jan 2024 to Mid-February 2024: Budget Development

January 18	Budget Forms sent to school leaders
January 19	Budget Form training for Principals (how to fill out the Forms)
January 23 - February 9	Budget Development meetings (most occur Jan 23 to Feb 2). Schools must have a balanced budget before leaving the table, especially if the school intends to request budget assistance.
February 2	Budget Assistance request deadline (Budget Assist Request Form)
February 7 and 8	Budget Assistance review and decisions communicated out to schools
February 9	<b>Budget Forms due back from schools balanced, including CSC forms acknowledging that the School Leader presented the Budget to the CSC</b>

# Class Sizes to CSC

<b>ECE</b>	Aldaz - 15 Hughes - 18 Rivera - 20	<b>3rd Grade</b>	Barrera - 24 Espitia - 23 Caldwell - 24 Rabin - 24
<b>Kindergarten</b>	McReynolds - 25 Blair - 22 Painter - 32 Zaragoza - 32	<b>4th Grade</b>	Mullins - 25 Wallace - 22 Romero - 27 Candee (4th/5th) - 27
<b>1st Grade</b>	Saiz - 30 Montecino - 30 Alvarez - 26 Barton - 25	<b>5th Grade</b>	Arias - 25 Powell - 24 Beatty - 26
<b>2nd Grade</b>	Johns - 27 Basin - 24 Figueroa - 35 Capriles - 35	<b>4th Grade Specials</b>	3 groups of 33

# ELD/SLD Class Sizes to CSC

## Key.

**ELD** - English Language Development (required for any student classified as a Multilingual Learner (MLL))

**SLD** - Spanish Language Development (for English speaking students in Dual Language)

**Nothing next to the teacher's name** - they're teaching language development (often through writing) to English speakers in English classes

<p><b>Kindergarten</b></p>	<p>McReynolds - 25 Blair (ELD) - 9 Painter (SLD) - 24 Zaragoza (SLD) - 23 Hammond (ELD) - 24</p>	<p><b>3rd &amp; 4th Grade</b></p>	<p>Barrera (SLD) - 29 Espitia (ELD) - 22 Caldwell - 23 Rabin (ELD) - 22 Mullins - 24 Wallace - 23 Romero (ELD) - 23 Candee (4th/5th) - (none as of now) Hammond (ELD) - 23</p>
<p><b>1st &amp; 2nd Grade</b></p>	<p>Saiz (ELD) - 33 Montecino (SLD) - 29 Alvarez (ELD) - 22 Barton (ELD) - 21 Hammond (ELD) - 32 Johns - 23 Basin - 23 Figueroa (SLD) - 22 Capriles (ELD) - 32</p>	<p><b>5th Grade</b></p>	<p>Arias (ELD) - 13 Powell - 23 Beatty - 23 Hammond (ELD) - 12</p>

**NEXT MEETING**

**JAN 3, 2024**

